

Latimer Road Wimbledon, SW19 1EW

£525,000 Freehold



A fantastic, two bedroom, Victorian ground floor freehold maisonette with a garden and no onward chain located moments from Wimbledon Broadway. This lovely flat has two bedrooms, a modern bathroom, a separate kitchen with door opening to the pretty garden and a large lounge with wood flooring and feature fireplace. To have a purpose built garden maisonette so close to Wimbledon town is rare. Coming with the bonus of the full freehold for the building, an early viewing is recommended.

Latimer Road, SW19
 Approximate Gross Internal Area = 58.1 sq m / 625 sq ft

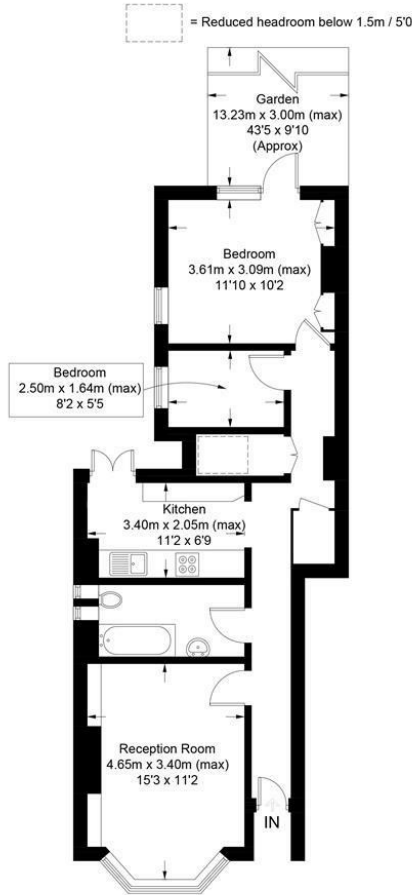

This floor plan is for representation purposes only and is not drawn to scale.
 The Gross Internal Area includes outbuildings shown on the plan.
 Whilst every attempt has been made to ensure the accuracy of the plan measurements of doors, windows and rooms are approximate only and should be checked before making any decisions reliant upon them.
 Copyright Bespokeplans.co.uk (ID864153)



- Victorian Maisonette
- Large double bedroom
- Second single bedroom/Study
- Spacious lounge
- Garden
- Hard wood flooring throughout
- No Onward Chain
- Full Freehold
- Current EPC Rating - D
- Council Tax Band C

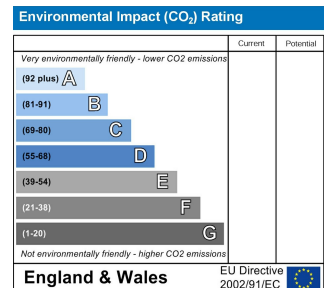
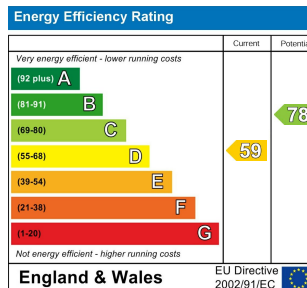

For Free Mortgage Quote and Best Mortgage Rates, call an Ellisons Mortgage Advisor on 020 8944 9494



Although these particulars are believed to be correct, their accuracy is not guaranteed and they do not form part of any contract.

Celebrating 30 years of successful Sales and Lettings in Merton

